

# Rocket 1604A (R1604A)

**4x NVMe Port to PCIe 5.0 x16 NVMe Switch AIC**



**Quick Installation Guide**

**V1.01**

# **System Requirements**

## **PC Requirements**

- System with a free PCIe5.0 (or 3.0 or 4.0) x16 slot
- All the Operating Systems with Native NVMe Driver

## **R1604A Kit Content**

- 1x R1604A NVMe Switch AIC
- 1x Quick Installation Guide
- 4x Additional M.2 Rubbers
- 1x K=8 70mm\*90mm\*0.75mm Thermal PAD
- 1x K=8 70mm\*90mm\*1mm Thermal PAD
- 1x K=3 70mm\*90mm\*1.5mm Thermal PAD

# R1604A Hardware

## Front View

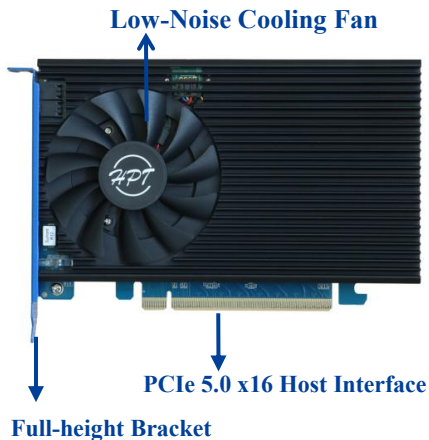

## LED View

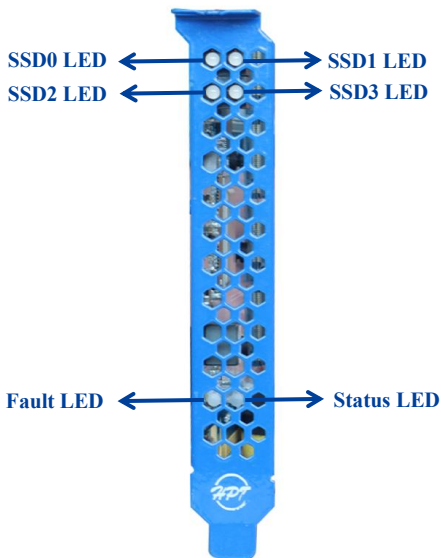

Note: Please refer to the detailed description of LED colors and their status in the R1604A NVMe Switch AIC User Guide on the official website.

## Hardware Installation

1. Use a wired ESD wrist strap that is properly grounded.
2. Unpack and remove the R1604A and check it for damage. If it appears damaged, please get in touch with HighPoint Technical Support.
3. Remove the five screws on the back of the R1604A that secure the heat sink to the PCB and lift the heat sink up from the right side to remove it.

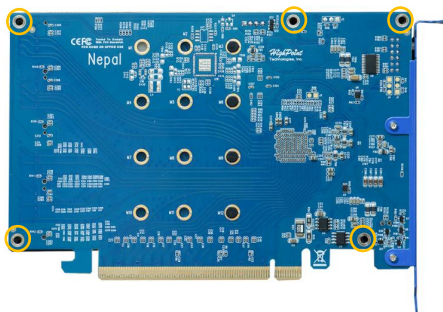

4. Install the thermal pads onto the R1604A PCB.  
**Note:** Omission of thermal pads on the R1604A PCB is permissible if your disk exhibits adequate heat dissipation.

- 1) Remove the blue film from one side of the thermal pads.
- 2) Align the thermal pad with the M.2 port and press gently to ensure a tight fit.

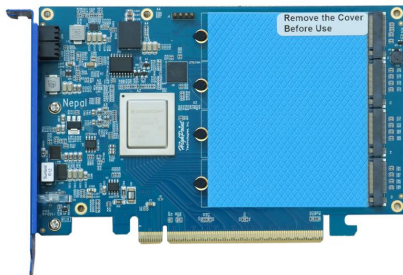

- 3) Remove the blue film from the other side of the thermal pads.



5. Install the NVMe SSDs to the R1604A.

- 1) Confirm the direction of the rubber (pointing in the opposite direction of the M.2 port).

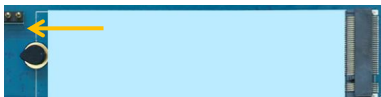

- 2) Gently insert the NVMe SSD into the M.2 connector.



- 3) Press the side of the rubber to align it and insert it into the retention hole on the end of the NVMe SSD.



- 4) Rotate the direction of the rubber so that it points to the M.2 port to secure the NVMe SSD better.



- 5) Repeat the above steps to install the remaining NVMe SSDs.

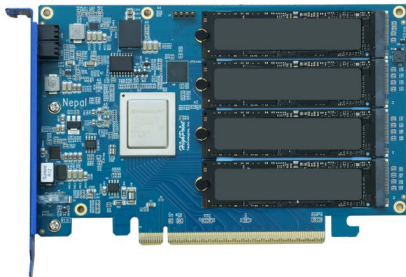

6. Install the heat sink to the R1604A PCB.
- 1) Remove the blue film from the thermal pad on the heat sink.

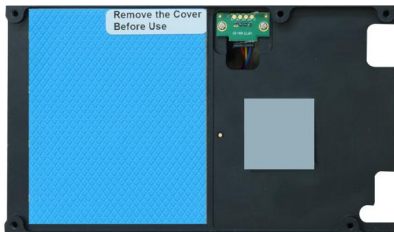

- 2) Align the left side of the heat sink with the PCB and carefully lower the right side.





- 2) Align the R1604A to one of the motherboard's available slots. Press down gently but firmly to seat the R1604A correctly in the slot.



8. Turn on the power to the system.

## Resources

Various guides are available for the R1604A.

For Documentation and more information about this product, please visit the following website:

<https://www.highpoint-tech.com/rocket-1604a-individual-page/>

### FAQ & Troubleshooting:

[FAQ - HighPoint Technologies, Inc. \(helpjuice.com\)](https://www.helpjuice.com/highpoint-tech)

## Customer Support

If you encounter any problems while utilizing the R1604A or have questions about this or any other HighPoint Technologies, Inc. product, please contact our Customer Support Department.

### Web Support:

<https://www.highpoint-tech.com/support-and-services>

### HighPoint Technologies, Inc. websites:

<https://www.highpoint-tech.com>